

microlife[®]

Be part of the great movement to
prevent stroke and heart disease

Let's work together
for better health

Microlife WatchBP
Professional Blood Pressure Monitors

www.watchbp.com

Table of Contents

Introduction

WatchBP - The Cardiovascular Management Solution	P.2
WatchBP Product Overview	P.3
Accuracy and Validations	P.4
Advanced Measurement Technology	P.6
Atrial Fibrillation Detection	P.7

WatchBP Office

WatchBP Office Afib	P.11
WatchBP Office ABI	P.13
WatchBP Office Central	P.15
WatchBP Office Basic	P.17
WatchBP Office Target	P.17

WatchBP 03 Ambulatory

WatchBP 03 Ambulatory	P.18
-----------------------------	------

WatchBP Home

WatchBP Home	P.23
WatchBP Home A	P.24
WatchBP Home N	P.25
WatchBP Home S	P.26
WatchBGP	P.26

WatchBP Cuffs

WatchBP Cuffs	P.27
---------------------	------

Overview and References

WatchBP Features Overview	P.29
References	P.30

WatchBP

The cardiovascular management solution

Clinical blood pressure measurement has limited accuracy because of:

- √ Blood pressure variability
- √ White coat effect/hypertension
- √ Masked hypertension

Therefore guidelines also recommend:

- √ Ambulatory (24-hour) blood pressure measurement
- √ Self-measurement of blood pressure at home

Additional cardiovascular screening is recommended for:

- √ Peripheral arterial disease
 - ankle brachial index (ABI)
 - inter-arm difference (IAD)
- √ Atrial fibrillation (Afib)

Microlife WatchBP presents a solution that makes screening for these important cardiovascular risks easy, fast and accurate.



Recommended by NICE



Afib Detection



WatchBP Product Overview



Ambulatory blood pressure measurement

Office blood pressure measurement

Self-measurement of blood pressure at home

High Accuracy and Clinically Validated

All Microlife devices have passed BHS & ESH validation protocols

Clinical devices

WatchBP device	Validation protocol		Circumstance
	BHS	ESH	
Office		Pass	At rest
Office ABI	A/A	Pass	At rest
		Pass	L-XL size cuff
Office AFIB		Pass	WatchBP Office Equivalence
Office Target		Pass	BP A100 Equivalence

Accuracy of Blood Pressure Monitors

Over the past 10 years Microlife devices have passed more than 20 validations according to both the BHS and ESH protocols. These include validations for special patient groups such as patients with high blood pressure during pregnancy (pre-eclampsia), end stage renal disease and for those with obesity.

Ambulatory blood pressure monitoring devices

WatchBP device	Validation protocol		Circumstance
	BHS	ESH	
03		Pass	At rest
		Pass	L-XL size cuff

Self-measurement devices

WatchBP device	Validation protocol		Circumstance
	BHS	ESH	
Home	A/A	Pass	At rest
	A/A		Pregnancy
	B/A		Pre-eclampsia
	A/A		L-XL Cuff
Home A	A/A	Pass	At rest
		Pass	L-XL size cuff
Home N		Pass	WatchBP Home Equivalence
Home S		Pass	WatchBP Home Equivalence

* See also References at P30



End stage renal disease



Microlife provides validated blood pressure monitors for patients with end stage renal disease

Patients with moderate to severe renal disease have a very high incidence of hypertension, paired with stiff (calcified) arteries. As automated measurements can be influenced by stiff arteries, a special validation is required before blood pressure monitors can be recommended for use among patients with end stage renal disease.

Available Models:



WatchBP Home



WatchBP Home A



WatchBP Home N



WatchBP Home S

Pre-eclampsia



Microlife WatchBP Home is accurate for use in pregnancy and Pre-eclampsia

Most oscillometric blood pressure monitors underestimate blood pressure in pre-eclampsia. For this reason, oscillometric blood pressure monitors may only be recommended for use in pregnancy when specifically tested in this special patient group. The WatchBP Home allows pregnant women to measure their blood pressure at home which could reduce the number of hospital visits and may help to make motherhood safer.

Pre-eclampsia

Pre-eclampsia is defined as new hypertension and substantial proteinuria after 20 weeks gestation. Due to the unpredictable nature of pre-eclampsia hypertensive women must have their blood pressure measured frequently.



WatchBP Home

3 consecutive measurements



Guidelines recommend taking at least two blood pressure readings each time and average the measurements

The advantages of 3 consecutive measurements

- Superior reliability for blood pressure monitoring.
- Performing three sequential measurements diminishes the influence of an occasional deviating (high) reading.

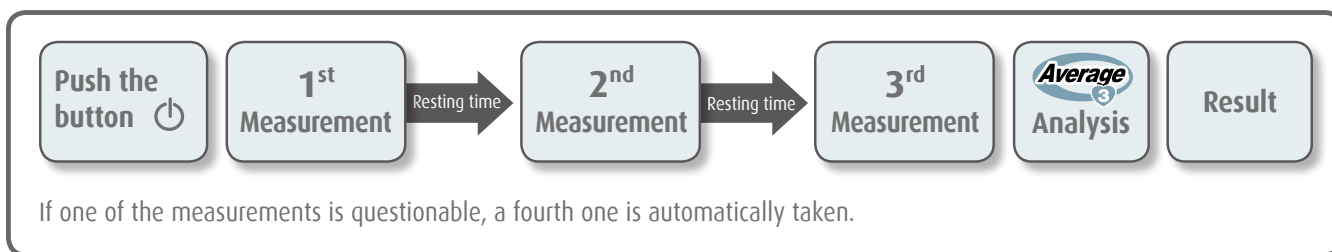

Peripheral Arterial Disease

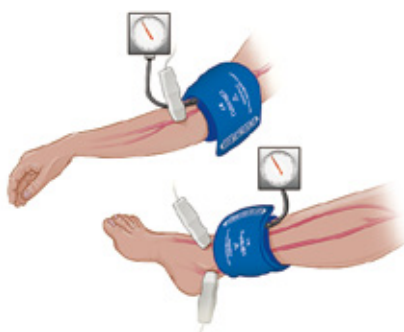

Ankle brachial index is commonly assessed with a Doppler device. This method is time consuming and prone to error.

Peripheral Arterial Disease (PAD)

50% of all patients have no symptoms

Peripheral arterial disease (PAD) is an important, frequently occurring, cardiovascular risk factor that often remains undetected for too long. Patients with PAD have a three-fold higher risk of myocardial infarction, stroke and death. A recommended test for diagnosing PAD is performing ankle-arm measurements to assess the ankle brachial index (ABI). In general clinical practice ABI is often determined with a Doppler device. However, this method is time consuming and requires skills from the observer and therefore is not performed as well and as frequently as it should.



Fatty substances on the arterial wall

Peripheral arterial disease

WatchBP Office ABI, for easy, fast and accurate ABI assessment



Early detection of atrial fibrillation can reduce the risk of stroke by 68%

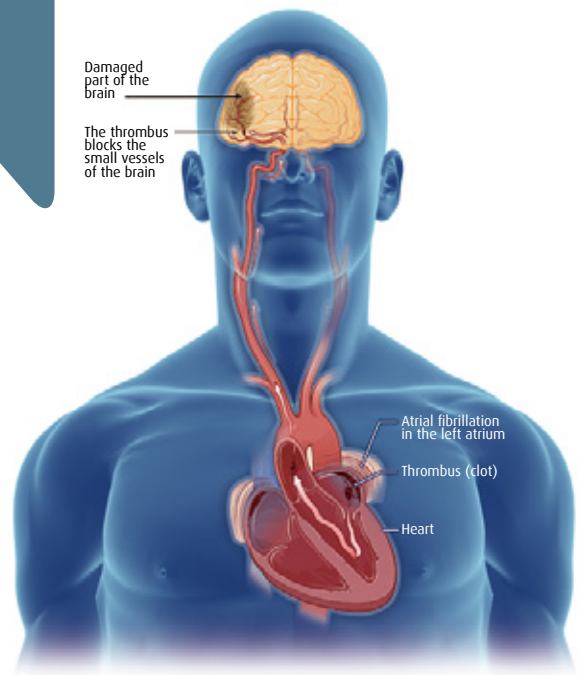

Stroke due to atrial fibrillation



Atrial fibrillation (Afib)

Afib is the most common sustained cardiac arrhythmia occurring in 5% of the population of 65 years and above and in 14% among those older than 85 years. Afib leads to a 5-fold higher risk of stroke and is responsible for 20% of all strokes. Many people have no symptoms from Afib and therefore remain undiagnosed, whereas early treatment can reduce the risk of stroke by 68%.

WatchBP monitors with atrial fibrillation (Afib) detection system

WatchBP monitors with implemented Afib detection system allow patients to be screened for Afib during blood pressure measurement. The Afib detection system has convincingly proven its accuracy, and showed that it leads to increased detection of new patients with Afib when used in general clinical practice.

Early detection of Afib followed by adequate treatment can reduce the risk of a stroke by 68%

Wrist palpation



Wrist palpation, although commonly performed, has a low reliability.

Best clinical practice



A symbol appears on the LCD screen when Afib is detected.



Recommended by NICE

The National Institute for Health and Clinical Excellence (NICE) officially recommends using the WatchBP Home A during routine blood pressure measurement for all GP's in the United Kingdom. www.nice.org.uk/MTG13



“WatchBP Home A should be used for hypertension monitoring in primary care”

Tested and approved for detecting atrial fibrillation

WatchBP Afib detects atrial fibrillation with high accuracy (sensitivity 97-100% - specificity 89%) as demonstrated in multiple comparative studies with ECG.

WatchBP Office

**Microlife WatchBP Office,
guidelines based
professional blood pressure
monitors**





Afib detection

Screens for atrial fibrillation during blood pressure measurement.



3 consecutive measurements

For accurate blood pressure measurement and better Afib detection.



ABI assessment

Fast, easy and reliable simultaneous ankle-arm blood pressure measurement for screening of peripheral arterial disease.



PC link

Transmit all measurement data to PC via USB connection.

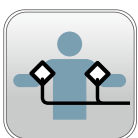

Double arm measurement

Unique dual-cuff design for assessing inter-arm blood pressure differences.



Central blood pressure measurement

Non-invasive, reliable method based on brachial pulse volume plethysmography (PVP) waveforms.



Auscultatory mode

For use in e.g. elderly, obese and those with arrhythmia.



WatchBP Office Afib

WatchBP Office Afib

Dual-cuff blood pressure monitor with atrial fibrillation detection and auscultatory measurement function.



WatchBP Office ABI

WatchBP Office ABI

Cardiovascular Screening Device, Dual-cuff blood pressure monitor with atrial fibrillation detection and Ankle-Brachial Index function.



WatchBP Office Central

WatchBP Office Central

Cardiovascular Screening Solution, Dual-cuff blood pressure monitor with atrial fibrillation detection, Ankle-Brachial Index assessment and central blood pressure measurement function.



WatchBP Office Basic

WatchBP Office Basic

Blood pressure monitor with atrial fibrillation detection and auscultatory measurement function.



WatchBP Office Target

WatchBP Office Target

Blood pressure monitor with built-in blood pressure targets.

Screen for AFIB & IAD A leading risk factor for stroke



WatchBP Office Afib



Afib detection



3 consecutive measurements



Double arm measurement



Auscultatory mode



PC link

- ✓ Atrial fibrillation (Afib) detection.
- ✓ Dual-cuff design for simultaneous measurement on both arms to assess the Inter-Arm Difference (IAD).
- ✓ Auscultatory mode, for use in e.g. elderly, obese and those with arrhythmia.
- ✓ Software CD included, and can also be downloaded from the website: www.watchbp.com



Atrial fibrillation detection

WatchBP Afib detects atrial fibrillation with high accuracy (sensitivity 97-100% - specificity 89%) as demonstrated in multiple comparative studies with ECG.

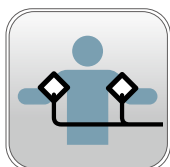

The most reliable tool for determining inter-arm blood pressure differences

Inter-arm difference (IAD) in blood pressure is an important cardiovascular risk predictor. Therefore, blood pressure must be measured in both arms at the first clinical visit.

IAD Threshold	
Diastolic ≥ 10mmHg	Systolic ≥ 20mmHg



Operation Mode:

Mode	Measurements	Interval time	Afib detection	Double arm measurement	PC link
Routine	3	15" default 30"/45"/60" selectable	●	-	●
Auscult	1	-	-	-	-
Screen	3	15" default 30"/45"/60" selectable	●	●	●





WatchBP Office ABI

Cardiovascular Screening Device



Afib detection



3 consecutive measurements



Double arm measurement



ABI assessment



PC link

- ✓ Fast, easy and accurate Ankle Brachial Index (ABI) assessment.
- ✓ Atrial fibrillation (Afib) detection.
- ✓ Dual-cuff design for simultaneous measurement on both arms to assess the Inter-Arm-Difference (IAD).
- ✓ Software CD included, and can also be downloaded from the website:
www.watchbp.com

Ankle brachial index assessment : screening for peripheral arterial disease

Presentation of the measurement results

On the device

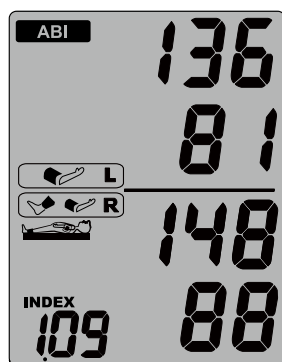

On the PC

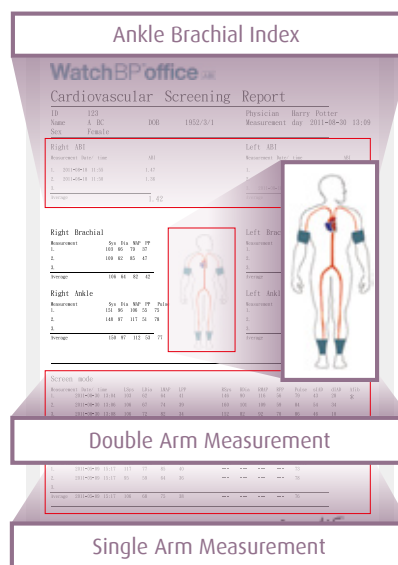
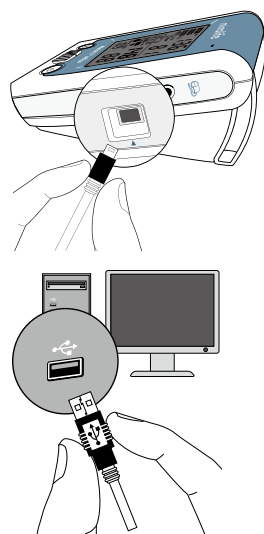

Operation Mode:

Mode	Measurements	Interval time	ABI assessment	Afib detection	Double arm measurement	PC link
ABI	1	-	●	-	-	●
Routine	3	15" default 30"/45"/60" selectable	-	●	-	●
Screen	3	15" default 30"/45"/60" selectable	-	●	●	●





WatchBP Office Central

Cardiovascular Screening Solution



Afib detection



3 consecutive measurements



Double arm measurement



ABI assessment



PC link



Central Blood pressure measurement

- ✓ Non-invasive central blood pressure measurement.
- ✓ Fast, easy and accurate Ankle Brachial Index (ABI) assessment.
- ✓ Atrial fibrillation (Afib) detection.
- ✓ Dual-cuff design for simultaneous measurement on both arms to assess the Inter-Arm-Difference(IAD).

Central blood pressure

Central blood pressure is the pressure in the aorta, the largest artery that originates from the heart. Central blood pressure measurement may better correlate with cardiovascular risk than upper arm blood pressure measurement because the aorta is more close to the heart and brain, the most vital organs of the body.

The WatchBP Office Central has surpassed all requirements of the international standards



The aorta distributes oxygenated blood to all parts of the body.

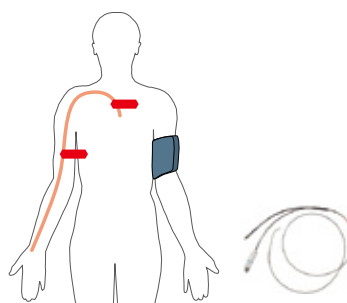

The WatchBP Office central has been validated against intra-arterial blood pressure measurement.



Operation Mode:

Mode	Measurements	Interval time	Central BP measurement	Afib detection	Double arm measurement	PC link	ABI assessment
ABI	1	-	-	-	-	●	●
Routine	3	15" default 30"/45"/60" selectable	●	●	-	●	-
Screen	3	15" default 30"/45"/60" selectable	-	●	●	●	-



WatchBP Office Basic



Afib detection



3 consecutive measurements



Auscultatory mode



PC link



Clinical blood pressure monitor with atrial fibrillation detection

- ✓ Blood pressure measurement and screening for atrial fibrillation at the same time.
- ✓ Easy and reliable automated blood pressure measurement.
- ✓ Auscultatory mode.

WatchBP Office Target



3 consecutive measurements



Clinical blood pressure monitor with built-in blood pressure targets

- ✓ Built-in blood pressure targets at 140/90 mmHg for routine measurements; and 130/80mmHg for high risk patients.
- ✓ Display with color for patient education.
- ✓ Calculated difference from target value.

WatchBP 03

Ambulatory blood pressure measurement





Highly Affordable

WatchBP 03 Ambulatory

Professional 24-hour blood pressure monitor

- ✓ Highly affordable.
- ✓ Fully-programmable.
- ✓ Lightweight and compact.
- ✓ Pill intake recording button.
- ✓ PC connectivity via USB.
- ✓ Software CD included, and can also be downloaded from the website: www.watchbp.com
- ✓ Reports provided in PDF, Excel (or Open Office).
- ✓ Atrial fibrillation detection (optionally).

Available Models:

Model	24-hour ambulatory blood pressure monitor	Afib detection	PC link	Night-time measurement	Pill-button
WatchBP 03	●	-	●	●	●
WatchBP 03 Afib	●	●	●	●	●

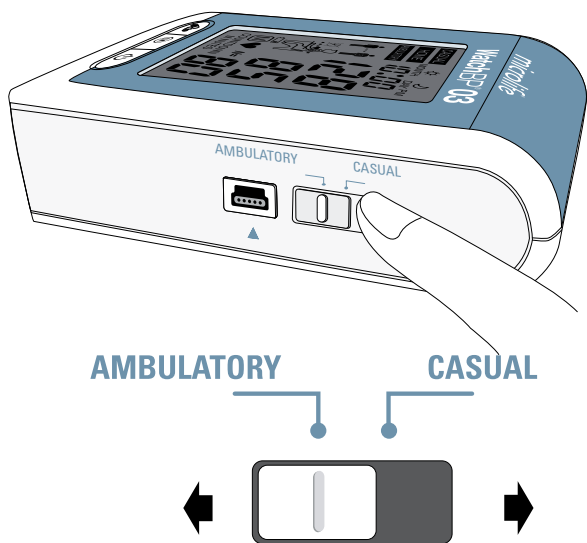

WatchBP 03 validated ambulatory blood pressure monitor

Easy to read one page PDF report

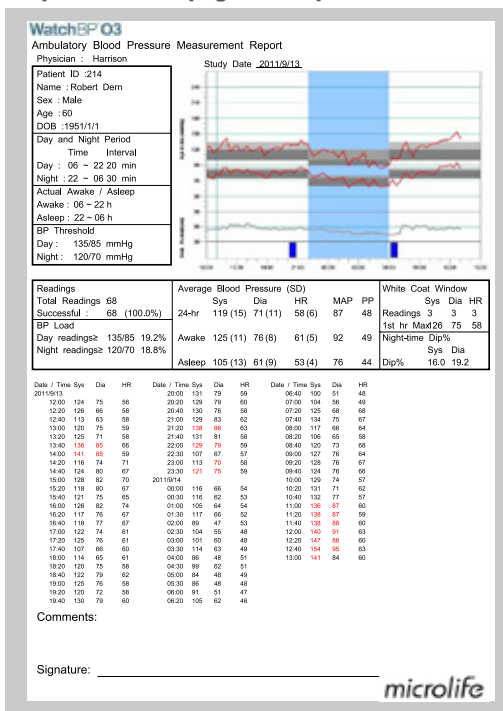

USB interface

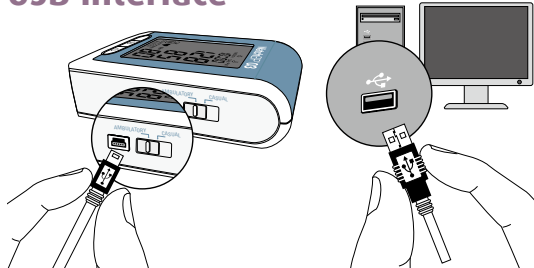

Pill-button for recording medication intake



WatchBP Home

For the best self-measurement of blood pressure at home





Afib detection

Screens for atrial fibrillation during blood pressure measurement.



3 consecutive measurements

For accurate blood pressure measurement and better Afib detection.



Night-time measurement

For measuring blood pressure during sleep.



Pill-button

For recording medication intake.



PC link

Transmits measurement data to PC via USB connection.



ESH/AHA/BHS guidelines embedded

Helps patients to perform 7-day self-measurement according to ESH/AHA/BHS guidelines.



WatchBP Home

WatchBP Home

Monitoring hypertension and suitable for use in pregnancy and pre-eclampsia.



WatchBP Home A

WatchBP Home A

Monitoring hypertension and atrial fibrillation.



WatchBP Home N

WatchBP Home N

Helps to collect accurate day and night blood pressure measurements for a good overview of the daily blood pressure pattern.



WatchBP Home S

WatchBP Home S

Simultaneously screening for hypertension and atrial fibrillation at home. Animated reminder to warn for risk factors.



WatchBGP

WatchBGP

2 in 1 blood pressure and blood glucose monitor.



WatchBP Home



ESH/AHA/BHS
guidelines embedded



PC link



DIAG.

Diagnostic mode

7-day self-measurement program that strictly follows ESH/AHA/BHS guidelines.

← 7 Working days at home →

	1	2	3	4	5	6	7
☀ Morning 06:00~09:00	✓	✓	✓	✓	✓	✓	✓
🌙 Night 18:00~21:00	✓	✓	✓	✓	✓	✓	✓

1 measurement = 2 readings



USUAL

Usual mode

For single measurement at any time (250 memory).

Microlife WatchBP Home, also accurate for use in pregnancy and pre-eclampsia





WatchBP Home A



Afib detection



ESH/AHA/BHS guidelines embedded



3 consecutive measurements



PC link



Recommended by NICE (UK)



Usual mode
(with Afib detection)
3 consecutive measurements for screening for Afib (250 memory).



Diagnostic mode
(with Afib detection)
7-day self-measurement program that strictly follows ESH/AHA/BHS guidelines.

WatchBP Analyzer Home A

Personal Information		Average without full day		96.88%		microlife		
Name	Michael Lee	Device	WatchBP Home A	Time	Sys	Dia	Pulse	
Phone (to call for support)	001 234 567 890	Device	WatchBP Home A	10:36	113	67	74	
Date of birth (YYYY-MM-DD)	1975-01-01	Device	WatchBP Home A	10:38	112	74	72	
		Device	WatchBP Home A	22:42	109	67	67	
		Device	WatchBP Home A	22:43	115	70	66	
11/1/2010								
Time	Sys	Dia	Pulse	21/1/2010	Time	Sys	Dia	Pulse
10:36	113	67	74	08:00	116	76	72	
10:38	112	74	72	08:05	114	77	71	
21:44	109	73	68	08:10	119	77	74	
21:47	115	76	69	08:15	111	72	70	
18/1/2010								
Time	Sys	Dia	Pulse	22/1/2010	Time	Sys	Dia	Pulse
06:49	112	73	70	08:05	111	76	72	
08:00	109	72	67	08:05	113	74	70	
20:04	115	72	70	08:10	119	77	74	
20:05	129	71	74	08:15	111	72	70	
16/1/2010								
Time	Sys	Dia	Pulse	23/1/2010	Time	Sys	Dia	Pulse
08:13	112	69	68	08:13	112	69	68	
08:14	108	70	71	08:14	108	70	71	
18:28	121	74	70	08:16	106	67	70	
18:28	114	68	74	20:18	102	67	74	

WatchBP Home



WatchBP Home N



Night-time Measurement



Afib detection



3 consecutive measurements



Pill-button

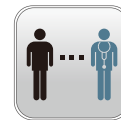

ESH/AHA/BHS guidelines embedded



PC link

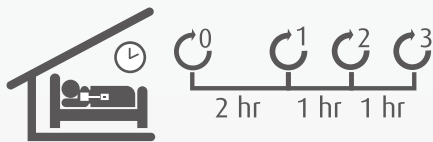

For monitoring blood pressure during sleep.



USUAL

Usual mode (with Afib detection)

3 consecutive measurements for screening for Afib (250 memory).



DIAG.

Diagnostic mode (with Afib detection)

7-day self-measurement program that strictly follows ESH/AHA/BHS guidelines.

WatchBP Analyzer Home N

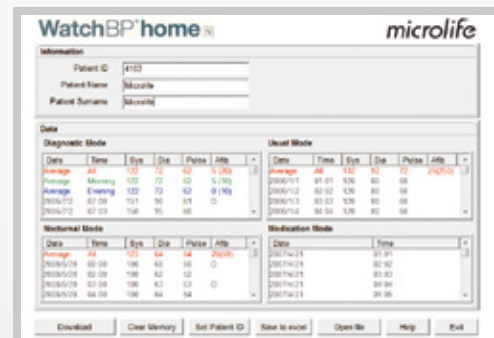

WatchBP Home S



Home blood pressure monitor with atrial fibrillation detection function

- ✓ Measuring blood pressure and screening for atrial fibrillation at the same time.
- ✓ Easy, reliable and affordable automated blood pressure measurement device.

WatchBGP

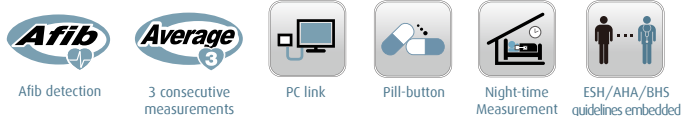

2 in 1 blood pressure and blood glucose monitor

- ✓ Blood glucose and blood pressure measurement.
- ✓ Validated for diabetes patients and patients with end stage renal disease.
- ✓ Strictly follow ESH/AHA/BHS guidelines for blood pressure measurement.
- ✓ Monitoring blood pressure during sleep.

Cuffs, as important as the blood pressure monitor

Using the wrong size cuff is a major cause for erroneous blood pressure measurement

All cuff are both latex and PVC free

Soft Upper Arm

WatchBP Office (Washable cuffs available in both nylon and cotton)

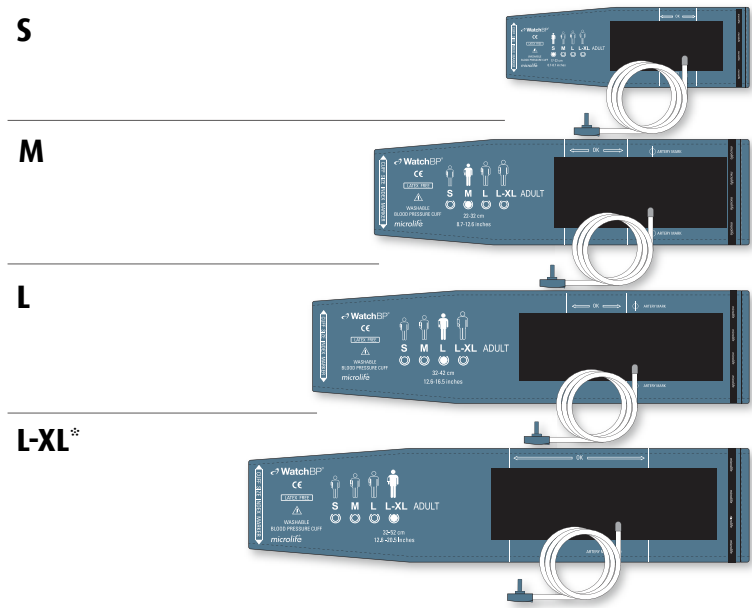

Cuff connector



For Office Afib,
Office ABI



For Office Basic,
Office Target

WatchBP 03 Ambulatory (Washable cuffs available in both nylon and cotton)

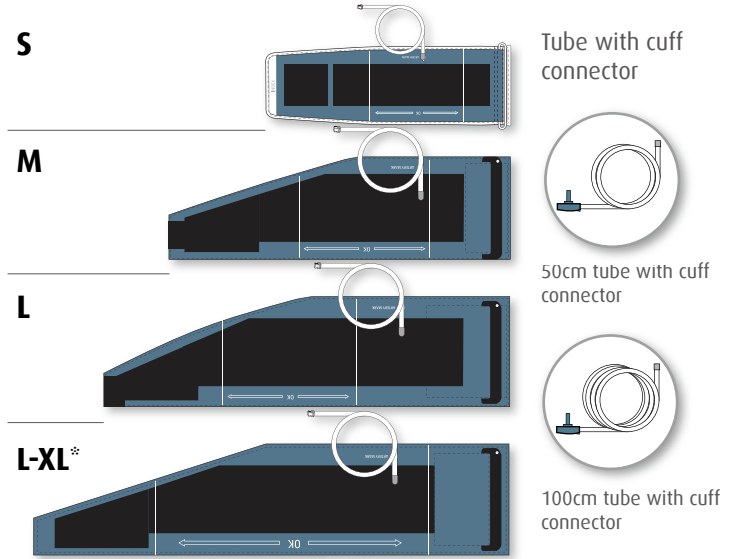

Tube with cuff connector

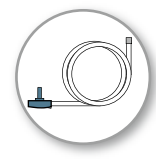

50cm tube with cuff connector

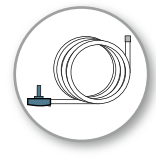

100cm tube with cuff connector

WatchBP Home

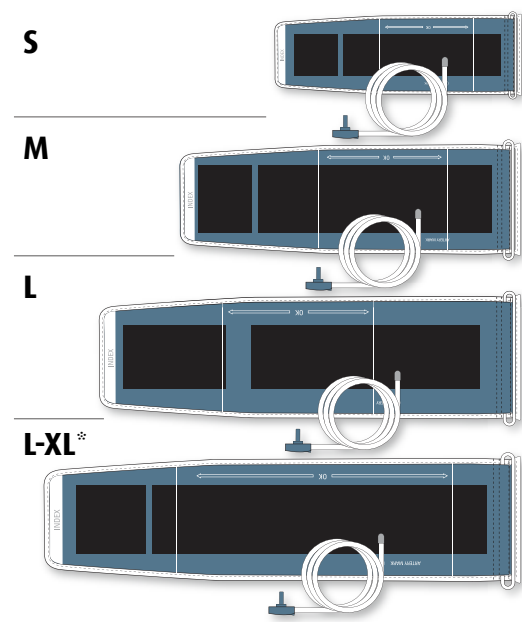

* the L-XL cuff has been validated for use among patients with large arms

Soft Ankle

WatchBP Office ABI/ Central

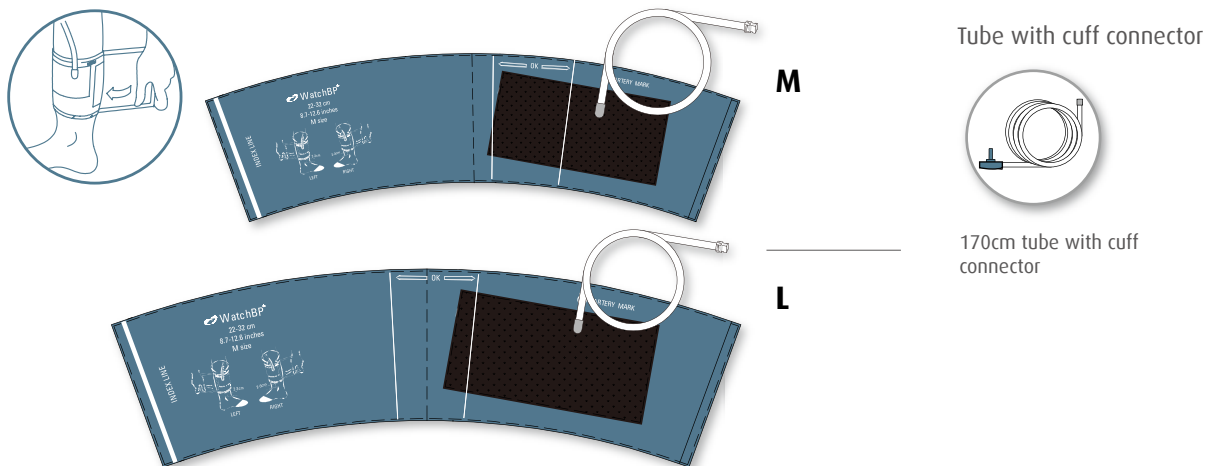

Upper Arm - Single Patient Use (Disposable)

WatchBP

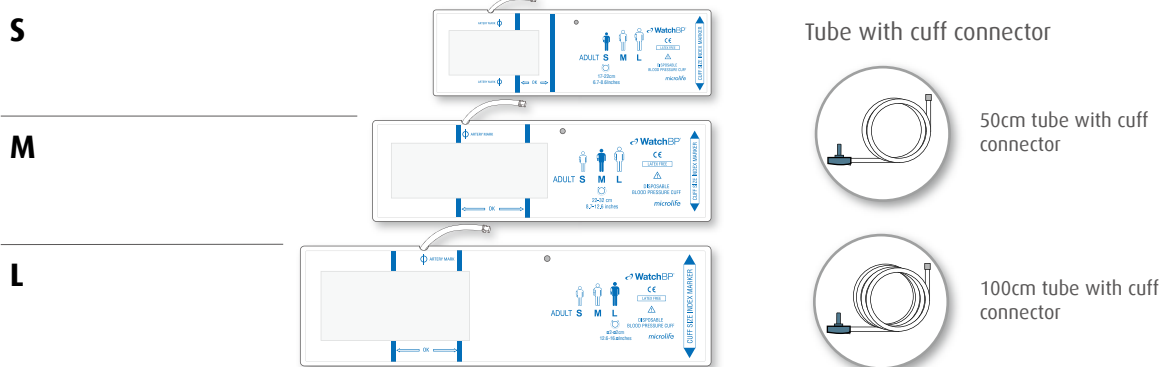

Upper Arm - Rigid

WatchBP Office

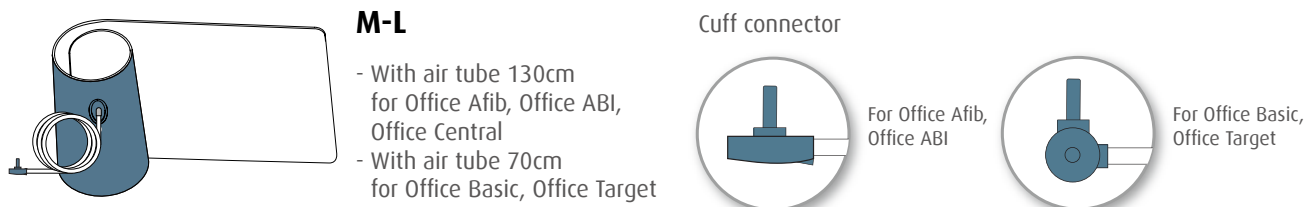

Cuff	Upper arm cuff					Ankle cuff	
	S	M	M-L	L	L-XL	M	L
Measures (cm)	17-22	22-32	22-42	32-42	32-52	22-32	32-42
Measures (Inches)	6.7-8.7	8.7-12.6	8.7-16.5	12.6-16.5	12.6-20.5	8.7-12.6	12.6-16.5

WatchBP features overview

WatchBP Office

Device	Single measurement	3 consecutive measurements	Double arm measurement	Auscultatory mode	Afib detection	ABI assessment	PC link	Central BP measurement
WatchBP Office Afib	●	●	●	●	●		●	
WatchBP Office ABI	●	●	●		●	●	●	
WatchBP Office Central	●	●	●		●	●	●	●
WatchBP Office Basic	●	●		●	●		●	
WatchBP Office Target	●	●						

WatchBP 03

Device	24-hour ambulatory BP monitoring	Afib detection	PC link	Night-time measurement	Pill-button
WatchBP 03	●		●	●	●
WatchBP 03 Afib	●	●	●	●	●

WatchBP Home

Device	Single measurement	3 consecutive measurements	ESH/AHA/BHS guidelines embedded	Afib detection	PC link	Night-time measurement	Pill-button
WatchBP Home	●		●		●		
WatchBP Home A	●	●	●	●	●		
WatchBP Home N	●	●	●	●	●	●	●
WatchBP Home S	●	●		●			
WatchBGP	●	●	●	●	●	●	●

References

1. Stergiou, G.S., *et al.*, Assessment of the diurnal blood pressure profile and detection of non-dippers based on home or ambulatory monitoring. *Am J Hypertens.* 2012. 25: 974-8.
2. Ishikawa, J., *et al.*, Automatic office blood pressure measured without doctors or nurses present. *Blood Press Monit.* 2012. 17: 96-102.
3. Cheng, H.M., *et al.*, Measurement Accuracy of a Stand-Alone Oscillometric Central Blood Pressure Monitor: A Validation Report for Microlife WatchBP Office Central. *Am J Hypertens.* 2013. 26: 42-50.
4. Andreadis, E.A., *et al.*, Automated office versus home measurement of blood pressure in the assessment of morning hypertension. *Blood Press Monit.* 2012. 17: 24-34.
5. Verberk, W.J., *et al.*, Accuracy of oscillometric blood pressure monitors for the detection of atrial fibrillation: a systematic review. *Expert Rev Med Devices.* 2012. 9: 635-40.
6. Saladini, F., *et al.*, Accuracy of Microlife WatchBP Office ABI monitor assessed according to the 2002 European Society of Hypertension protocol and the British Hypertension Society protocol. *Blood Press Monit.* 2011. 16: 258-61.
7. Masiero, S., *et al.*, Accuracy of the Microlife large-extra large-sized cuff (32-52 cm) coupled to an automatic oscillometric device. *Blood Press Monit.* 2011. 16: 99-102.
8. Lohmann, F.W., *et al.*, Interarm differences in blood pressure should be determined by measuring both arms simultaneously with an automatic oscillometric device. *Blood Press Monit.* 2011. 16: 37-42.
9. Kollias, A., *et al.*, Automated determination of the ankle-brachial index using an oscillometric blood pressure monitor: validation vs. Doppler measurement and cardiovascular risk factor profile. *Hypertens Res.* 2011. 34: 825-30.
10. Stergiou, G.S., *et al.*, Are there really differences between home and daytime ambulatory blood pressure? Comparison using a novel dual-mode ambulatory and home monitor. *J Hum Hypertens.* 2010. 24: 207-12.
11. Ragazzo, F., *et al.*, Validation of the Microlife WatchBP 03 device for clinic, home, and ambulatory blood pressure measurement, according to the International Protocol. *Blood Press Monit.* 2010. 15: 59-62.
12. Nakano, H., *et al.*, Self-Monitoring of Ambulatory Blood Pressure by the Microlife WatchBP 03 - An Application Test. *Clin Exp Hypertens.* 2011. 33: 34-40.
13. Bonso, E., *et al.*, Accuracy of a single rigid conical cuff with standard-size bladder coupled to an automatic oscillometric device over a wide range of arm circumferences. *Hypertens Res.* 2010. 33: 1186-91.
14. Wiesel, J., *et al.*, Detection of atrial fibrillation using a modified microlife blood pressure monitor. *Am J Hypertens.* 2009. 22: 848-52.
15. Stergiou, G.S., *et al.*, Diagnostic accuracy of a home blood pressure monitor to detect atrial fibrillation. *J Hum Hypertens.* 2009. 23: 654-8.
16. Chung, Y., *et al.*, Validation and compliance of a home monitoring device in pregnancy: microlife WatchBP home. *Hypertens Pregnancy.* 2009. 28: 348-59.
17. Stergiou, G.S., *et al.*, Validation of the Microlife Watch BP Office professional device for office blood pressure measurement according to the International protocol. *Blood Press Monit.* 2008. 13: 299-303.
18. Stergiou, G.S., *et al.*, Automated device that complies with current guidelines for office blood pressure measurement: design and pilot application study of the Microlife WatchBP Office device. *Blood Press Monit.* 2008. 13: 231-5.
19. Wiesel, J., *et al.*, Home monitoring with a modified automatic sphygmomanometer to detect recurrent atrial fibrillation. *J Stroke Cerebrovasc Dis.* 2007. 16: 8-13.
20. Stergiou, G.S., *et al.*, A tool for reliable self-home blood pressure monitoring designed according to the European Society of Hypertension recommendations: the Microlife WatchBP Home monitor. *Blood Press Monit.* 2007. 12: 127-31.
21. Stergiou, G.S., *et al.*, Validation of the Microlife WatchBP Home device for self home blood pressure measurement according to the International Protocol. *Blood Press Monit.* 2007. 12: 185-8.
22. Reinders, A., *et al.*, An accurate automated blood pressure device for use in pregnancy and pre-eclampsia: the Microlife 3BTO-A. *BJOG.* 2005. 112: 915-20.

Europe / Middle-East / Africa

Microlife WatchBP AG
Eспенstrasse 139
9443 Widnau, Switzerland
Tel: + 41 71 727 7000
Fax: + 41 71 727 7011
watchbp@microlife.ch
www.watchbp.com
www.watchbp.nl

WatchBP Microlife solutions B.V.

Mercator I
Toernooiveld 220
6525 EC Nijmegen
The Netherlands
watchbp@microlife.ch
www.watchbp.nl

Microlife Health Management Ltd.

St John's Innovation Centre
Cowley Road
Cambridge
CB4 0WS
United Kingdom
Tel: + 44 (0) 1223 422 444
Fax: + 44 (0) 1223 420 844
info@watchbp.co.uk
service@watchbp.co.uk
www.watchbp.co.uk

United States

Microlife Medical Home Solutions, Inc.
2801 Youngfield St., Suite 241
Golden, CO 80401, USA
Tel: + 1 303 274 2277
Fax: + 1 303 274 2244
www.mimhs.com
www.watchbp.com

Latin America / Canada

Microlife USA Inc.,
1617 Gulf to Bay Blvd, 2nd Floor
Clearwater, FL 33755, USA
Tel. +1-727-4425353
Fax. +1-727-4425331
msa@microlifeusa.com
www.watchbp.com

Magyarország : g`YSck

Microlife Hungary Ltd.
1096 Budapest,
Thaly Kálmán u. 22-24.
Tel: + 36 30 933 6159
Fax: + 36 1 705 3070
microlife@t-online.hu
www.watchbp.com

For more information, please visit: www.watchbp.com

Microlife Corporation is a global corporation working closely with medical societies, specialists and primary care physicians to create tools and solutions that advance healthcare for the benefit of both physicians and patients.

microlife®